

EXISTING CONDITIONS



NOT APPROVED FOR CONSTRUCTION

1" = 20'-0"
0 10 20 40

EXISTING CONDITIONS



BOAT RAMP

PARKING LOT

MOONLIGHT BROOK CULVERT AND EARTHEN LEVEE PARK CONNECTOR

WATERFRONT PLAZA

FIELDSTONE WALL

STONE REVETMENT

COLLAPSING STONE RUBBLE WALL

EXTENT OF PROPOSED LIVING SHORELINE

FISH WEIR

STONE RUBBLE WALL

MOONLIGHT BROOK

STONE REVETMENT

KAYAK STORAGE

BLUFF

EXISTING TIDAL MARSH SLOPE

FLOATING DOCK AND RUBBLE ABUTMENT

LAMPREY RIVER
EBB
FLOW

NOT APPROVED FOR CONSTRUCTION

1" = 20'-0"
0 10 20 40

PROPOSED LIVING SHORELINE

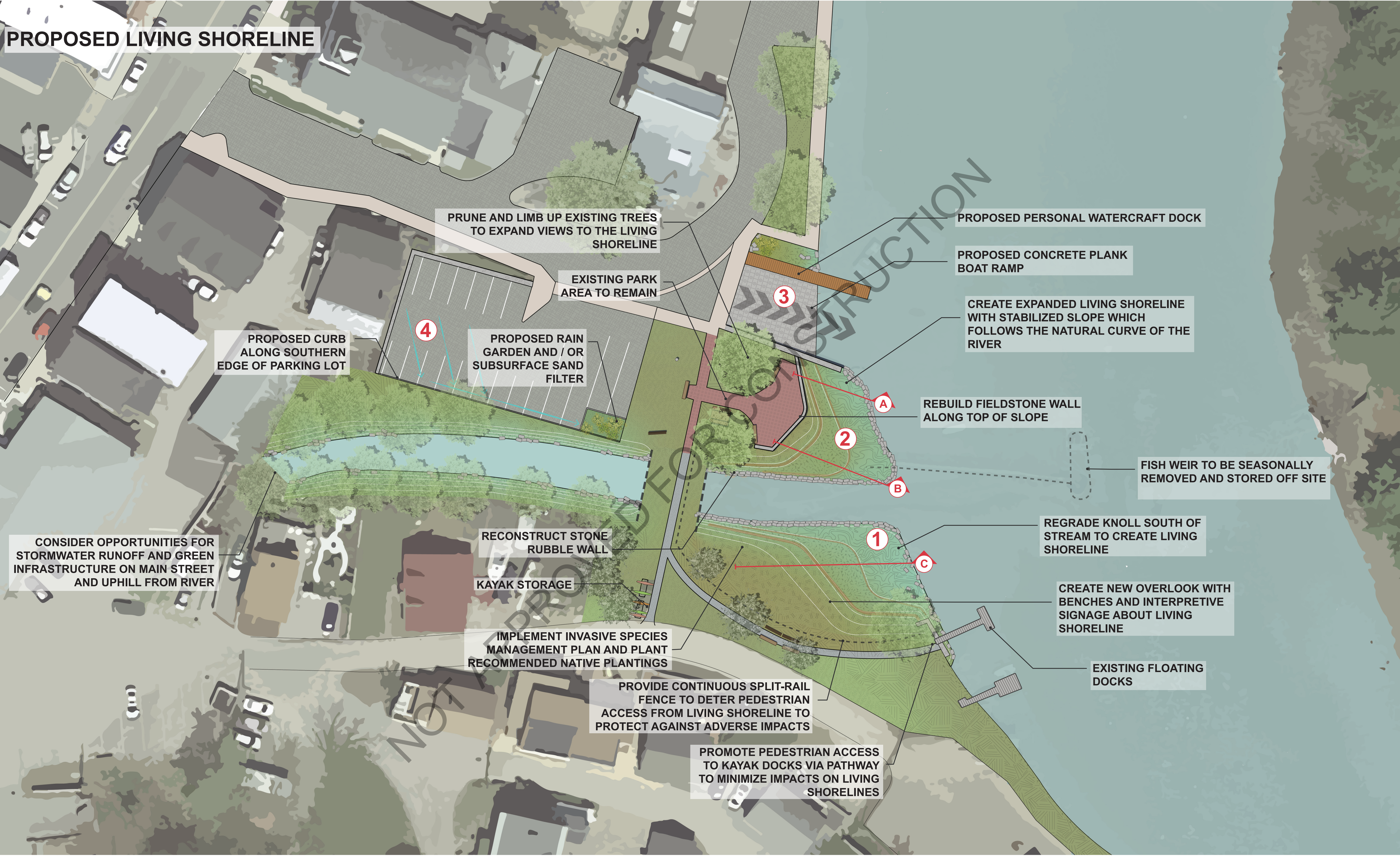

PRUNE AND LIMB UP EXISTING TREES TO EXPAND VIEWS TO THE LIVING SHORELINE

EXISTING PARK AREA TO REMAIN

PROPOSED PERSONAL WATERCRAFT DOCK

PROPOSED CONCRETE PLANK BOAT RAMP

CREATE EXPANDED LIVING SHORELINE WITH STABILIZED SLOPE WHICH FOLLOWS THE NATURAL CURVE OF THE RIVER

PROPOSED CURB ALONG SOUTHERN EDGE OF PARKING LOT

PROPOSED RAIN GARDEN AND / OR SUBSURFACE SAND FILTER

REBUILD FIELDSTONE WALL ALONG TOP OF SLOPE

FISH WEIR TO BE SEASONALLY REMOVED AND STORED OFF SITE

CONSIDER OPPORTUNITIES FOR STORMWATER RUNOFF AND GREEN INFRASTRUCTURE ON MAIN STREET AND UPHILL FROM RIVER

RECONSTRUCT STONE RUBBLE WALL

REGRADE KNOLL SOUTH OF STREAM TO CREATE LIVING SHORELINE

KAYAK STORAGE

CREATE NEW OVERLOOK WITH BENCHES AND INTERPRETIVE SIGNAGE ABOUT LIVING SHORELINE

IMPLEMENT INVASIVE SPECIES MANAGEMENT PLAN AND PLANT RECOMMENDED NATIVE PLANTINGS

EXISTING FLOATING DOCKS

PROVIDE CONTINUOUS SPLIT-RAIL FENCE TO DETER PEDESTRIAN ACCESS FROM LIVING SHORELINE TO PROTECT AGAINST ADVERSE IMPACTS

PROMOTE PEDESTRIAN ACCESS TO KAYAK DOCKS VIA PATHWAY TO MINIMIZE IMPACTS ON LIVING SHORELINES

1" = 20'-0"

PROPOSED LIVING SHORELINE - SECTION C

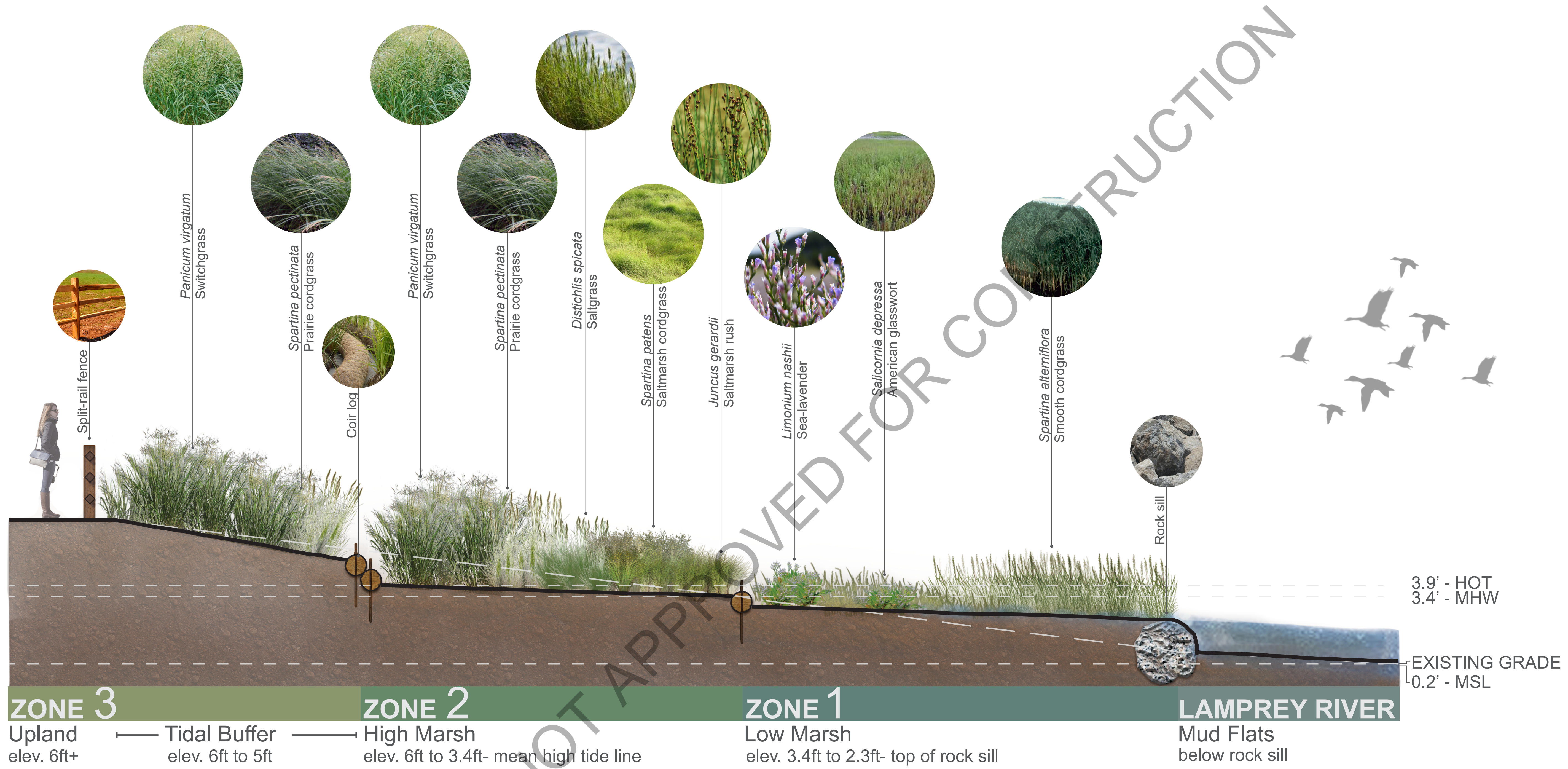

NOT APPROVED FOR CONSTRUCTION

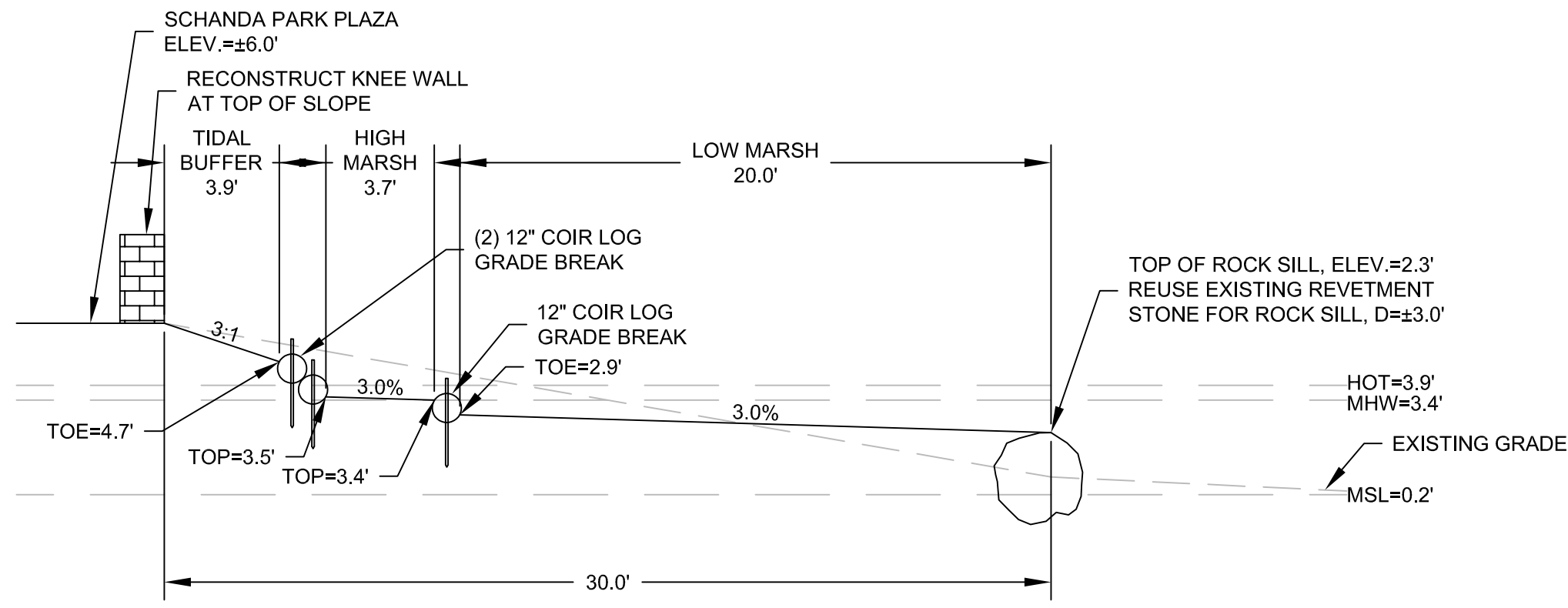

SECTION A
SCALE: 1"=5'

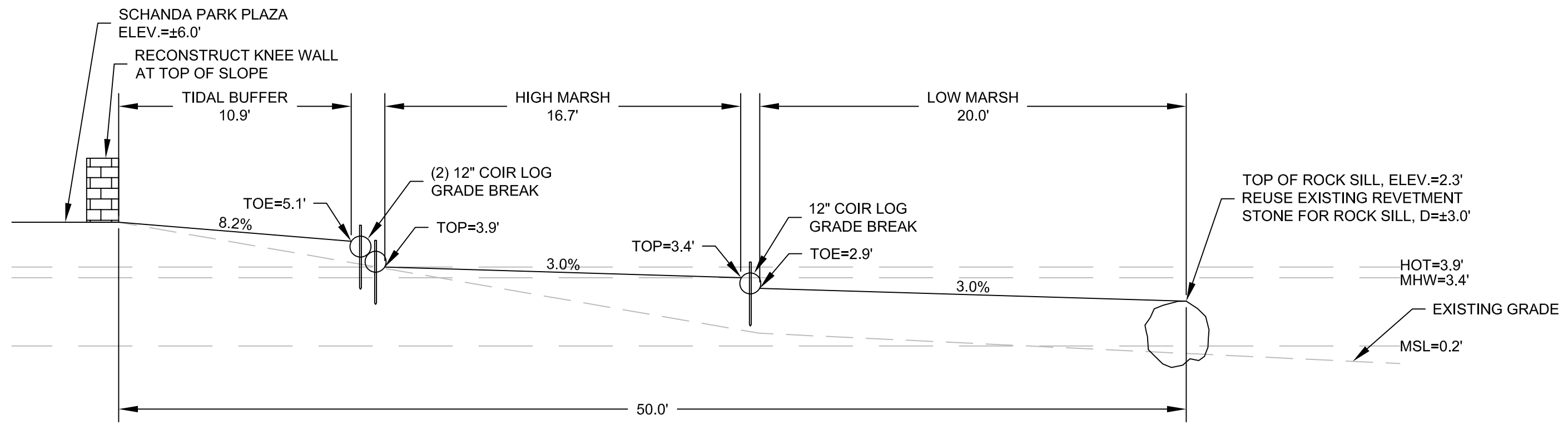

SECTION B
SCALE: 1"=5'

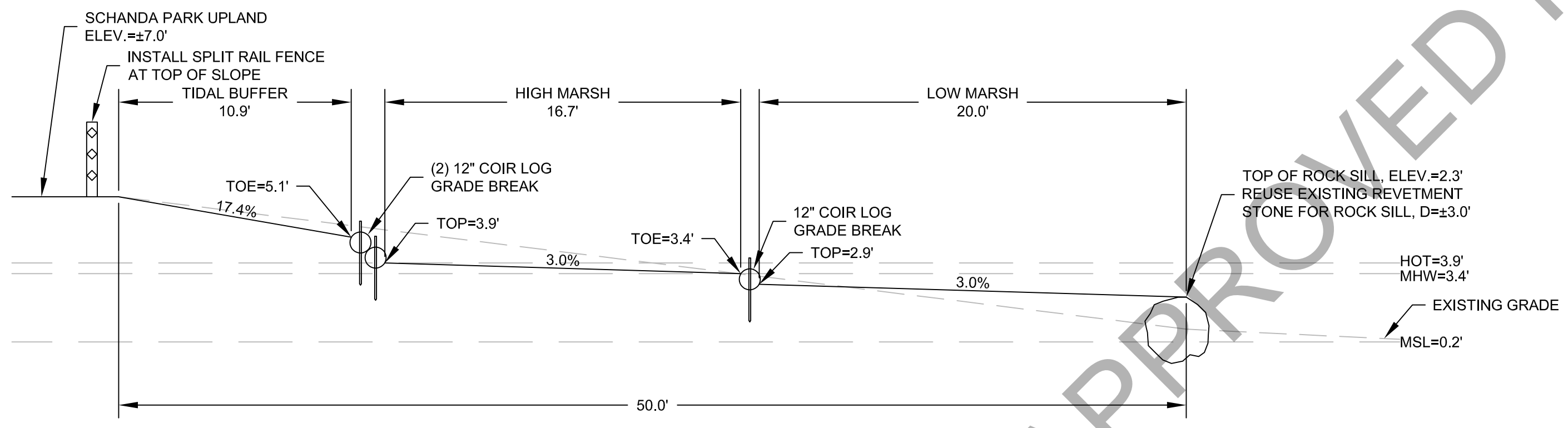

SECTION C
SCALE: 1"=5'

WATER LEVELS

1. WATER LEVELS BASED ON PRESSURE TRANSDUCER DATA GATHERED BETWEEN 9/2/21 AND 11/16/21.
2. WATER LEVEL DATA TIED TO NAVD88 BY SURVEYING WATER SURFACE ELEVATION AT 6:25 PM ON 10/11/21.
3. HIGHEST OBSERVABLE TIDE BASED ON HIGHEST TIDE RECORDED DURING THE DATA COLLECTION PERIOD.

	MLLW	NAVD88
HOT	7.1'	3.9'
MHHW	6.9'	3.7'
MHW	6.6'	3.4'
MSL	3.4'	0.2'
NAVD88	3.2'	0.0'
MLW	0.1'	-3.3'
MLLW	0.0'	-3.4'

NOT APPROVED FOR CONSTRUCTION